



सी. धारुमन  
सचिव

C. DHARUMAN  
SECRETARY

Web Site : www.nios.ac.in

E-mail : secretary@nios.ac.in

F-42-1 (1.57)/2015/NIOS/Admn/174  
[8 November, 2015]

Brig. B.D. Pandey, SM (Retd.)  
Managing Director  
Bharat Bhari Udyog Nigam Limited  
26, Raja Santosh Road,  
Alipore, Kolkata-700027

Subject: Construction of Regional Centre building at Plot allotted by DDA in Sector-30, Rohini, Delhi regarding.

Sir,

National Institute of Open Schooling (NIOS) is an autonomous organization under Ministry of Human Resource Development, Deptt. of School Education & Literacy, Govt. Of India having its Head Quarter located at A-24/25, Sector-62, Noida (U.P.). It provides education for Secondary, Senior Secondary and Vocational Courses through distance mode. It is the largest Open Schooling System in the World.

NIOS intends to construct a Green Campus with Multi Storied RCC framed structure having Curtain glazing, Solar System, Rain Water harvesting & Recycling of waste water plant, Centrally Air Conditioned, Earth Quake and Fire Proof in the building with Double Basement and stilt floor on the plot measuring area 4587 Square Metre allotted by DDA at Plot No. 12, PSP Pocket, (FC-15), Sector-30, Rohini on turnkey basis. A copy of lay out plan of land allotted by DDA is enclosed for reference. The time frame for construction of building shall be within a year. The provision in the building required shall be as under:

Sl.NO.	Description	Requirement/Provision
1.	Basement-I	For Storage of Answer books, Admission forms and other relevant records.
2.	Basement-II	Evaluation of Answer books
3.	Ground Floor	For Stilt Parking of Vehicles
4.	First Floor	For Facilitation Centre with 08 Computers on the pattern of passport office
5.	Second Floor	For Regional Director Office and other important
6.	Third Floor	Offices and Camp Office of the Chairman
7.	Fourth Floor	For Admission, Examination & Accounts Section
8.	Fifth Floor	Provision for some Offices of NIOS
9.	Sixth Floor	Conference Hall, Secrecy of Answer books
10.	Seven Floor	On Demand Examination

— 02 —

It is requested to kindly submit the blue print along with layout plan in CD/DVD, terms and conditions and Preliminary estimated cost of the building to be constructed by 31<sup>st</sup> December, 2015. A Display of the proposed building to be constructed will also be required in the form of CD/DVD as well as hard copy before the appropriate Committee of NIOS for which suitable date and time will be intimated to your office in due course.

Yours Sincerely,

  
I. C. Dharuman

Encl: As above.



# STANDING OVER/TAKING OVER ON 28.7.2015

As per letter no. F-3242/13/04/1331 dated 28.7.2015, issued by Mr. Director (H.A.), DDA regarding the physical possession of land marked A, B, C & D measuring 4588.24 sqm. Plot No. 12 at PGP Pocket (FC-3), Sector-30, Rohini, Phase IV. (which has been handed over on 28.7.2015 to the authorized representative Sh. Rajesh Gauram, Asstt. Director (Admin.) of National Institute of Open Schooling under MHRD for Regional Centre of NIOS purpose. The plot is free from encroachment.

(AREA = 4588.24 sqm)

FC-14  
SECTOR-29

ROAD 60.0 M R/W

Taken Over  
By NIOS  
Sh. Rajesh Gauram  
Asstt. Director (Admin.)  
NIOS

SIZE OF NIOS PLOT  
50.5M X 90.3M

P-5/c

BLOCK-B  
RECREATIONAL

RECREATIONAL

ROAD 30.0 M R/W

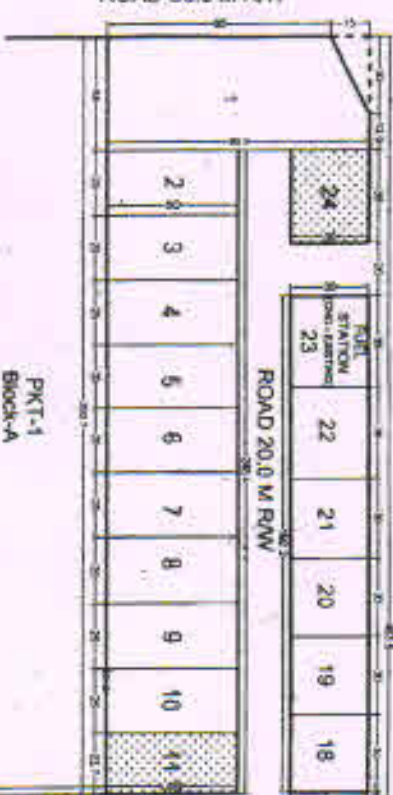

PLOT-1  
BLOCK-A  
SECTOR-30

PROVISIONAL ALLOTMENT TO DELHI POLICE FOR PLOT NO. 14 HAS BEEN MADE BY I.L. BRANCH, DDA. VIDE LETTER NO. F-25 (11/09/11) 1768 DATED 24-7-2013.

THE MODIFICATION FOR USE OF PLOT NO. 14 FROM PSP TO POLICE STATION WAS APPROVED BY OFFICIATING VC ON 17-10-2012 FOR SUBSEQUENT RETIFICATION BY SCREENING COMMITTEE.

THE RETIFICATION APPROVED IN 309th SCREENING COMMITTEE MEETING HELD ON 29-10-2012. VIDE ITEM NO. 131: 2012. THE SAME HAS BEEN VERIFIED BY DIR. (PLG-3), ROHINI DATED 10-12-2012 AND CERTIFIED BY DY DIR. (AR-4), COORDM. DATED 31-12-2012.

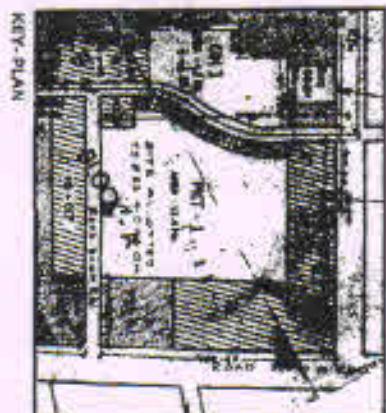

KEY PLAN

ROAD 20.0 M R/W



ROAD 80.0 M R/W

50.5M X 90.3M

PLOT-8  
RECREATIONAL

FC-3  
SECTOR-28

DELHI DEVELOPMENT AUTHORITY  
URBAN PROJECT PLANNING & DESIGN

AREA STATEMENT  
TOTAL AREA OF PLOT: 8.31 HA

Plot No	Use	Area (sq. m)
1	Plot No. 12	4588.24
2	Plot No. 13	4588.24
3	Plot No. 14	4588.24
4	Plot No. 15	4588.24
5	Plot No. 16	4588.24
6	Plot No. 17	4588.24
7	Plot No. 18	4588.24
8	Plot No. 19	4588.24
9	Plot No. 20	4588.24
10	Plot No. 21	4588.24
11	Plot No. 22	4588.24
12	Plot No. 23	4588.24
13	Plot No. 24	4588.24
14	Plot No. 25	4588.24
15	Plot No. 26	4588.24
16	Plot No. 27	4588.24
17	Plot No. 28	4588.24
18	Plot No. 29	4588.24
19	Plot No. 30	4588.24
20	Plot No. 31	4588.24
21	Plot No. 32	4588.24
22	Plot No. 33	4588.24
23	Plot No. 34	4588.24
24	Plot No. 35	4588.24
25	Plot No. 36	4588.24
26	Plot No. 37	4588.24
27	Plot No. 38	4588.24
28	Plot No. 39	4588.24
29	Plot No. 40	4588.24
30	Plot No. 41	4588.24
31	Plot No. 42	4588.24
32	Plot No. 43	4588.24
33	Plot No. 44	4588.24
34	Plot No. 45	4588.24
35	Plot No. 46	4588.24
36	Plot No. 47	4588.24
37	Plot No. 48	4588.24
38	Plot No. 49	4588.24
39	Plot No. 50	4588.24
40	Plot No. 51	4588.24
41	Plot No. 52	4588.24
42	Plot No. 53	4588.24
43	Plot No. 54	4588.24
44	Plot No. 55	4588.24
45	Plot No. 56	4588.24
46	Plot No. 57	4588.24
47	Plot No. 58	4588.24
48	Plot No. 59	4588.24
49	Plot No. 60	4588.24
50	Plot No. 61	4588.24
51	Plot No. 62	4588.24
52	Plot No. 63	4588.24
53	Plot No. 64	4588.24
54	Plot No. 65	4588.24
55	Plot No. 66	4588.24
56	Plot No. 67	4588.24
57	Plot No. 68	4588.24
58	Plot No. 69	4588.24
59	Plot No. 70	4588.24
60	Plot No. 71	4588.24
61	Plot No. 72	4588.24
62	Plot No. 73	4588.24
63	Plot No. 74	4588.24
64	Plot No. 75	4588.24
65	Plot No. 76	4588.24
66	Plot No. 77	4588.24
67	Plot No. 78	4588.24
68	Plot No. 79	4588.24
69	Plot No. 80	4588.24
70	Plot No. 81	4588.24
71	Plot No. 82	4588.24
72	Plot No. 83	4588.24
73	Plot No. 84	4588.24
74	Plot No. 85	4588.24
75	Plot No. 86	4588.24
76	Plot No. 87	4588.24
77	Plot No. 88	4588.24
78	Plot No. 89	4588.24
79	Plot No. 90	4588.24
80	Plot No. 91	4588.24
81	Plot No. 92	4588.24
82	Plot No. 93	4588.24
83	Plot No. 94	4588.24
84	Plot No. 95	4588.24
85	Plot No. 96	4588.24
86	Plot No. 97	4588.24
87	Plot No. 98	4588.24
88	Plot No. 99	4588.24
89	Plot No. 100	4588.24
90	Plot No. 101	4588.24
91	Plot No. 102	4588.24
92	Plot No. 103	4588.24
93	Plot No. 104	4588.24
94	Plot No. 105	4588.24
95	Plot No. 106	4588.24
96	Plot No. 107	4588.24
97	Plot No. 108	4588.24
98	Plot No. 109	4588.24
99	Plot No. 110	4588.24
100	Plot No. 111	4588.24
101	Plot No. 112	4588.24
102	Plot No. 113	4588.24
103	Plot No. 114	4588.24
104	Plot No. 115	4588.24
105	Plot No. 116	4588.24
106	Plot No. 117	4588.24
107	Plot No. 118	4588.24
108	Plot No. 119	4588.24
109	Plot No. 120	4588.24
110	Plot No. 121	4588.24
111	Plot No. 122	4588.24
112	Plot No. 123	4588.24
113	Plot No. 124	4588.24
114	Plot No. 125	4588.24
115	Plot No. 126	4588.24
116	Plot No. 127	4588.24
117	Plot No. 128	4588.24
118	Plot No. 129	4588.24
119	Plot No. 130	4588.24
120	Plot No. 131	4588.24
121	Plot No. 132	4588.24
122	Plot No. 133	4588.24
123	Plot No. 134	4588.24
124	Plot No. 135	4588.24
125	Plot No. 136	4588.24
126	Plot No. 137	4588.24
127	Plot No. 138	4588.24
128	Plot No. 139	4588.24
129	Plot No. 140	4588.24
130	Plot No. 141	4588.24
131	Plot No. 142	4588.24
132	Plot No. 143	4588.24
133	Plot No. 144	4588.24
134	Plot No. 145	4588.24
135	Plot No. 146	4588.24
136	Plot No. 147	4588.24
137	Plot No. 148	4588.24
138	Plot No. 149	4588.24
139	Plot No. 150	4588.24
140	Plot No. 151	4588.24
141	Plot No. 152	4588.24
142	Plot No. 153	4588.24
143	Plot No. 154	4588.24
144	Plot No. 155	4588.24
145	Plot No. 156	4588.24
146	Plot No. 157	4588.24
147	Plot No. 158	4588.24
148	Plot No. 159	4588.24
149	Plot No. 160	4588.24
150	Plot No. 161	4588.24
151	Plot No. 162	4588.24
152	Plot No. 163	4588.24
153	Plot No. 164	4588.24
154	Plot No. 165	4588.24
155	Plot No. 166	4588.24
156	Plot No. 167	4588.24
157	Plot No. 168	4588.24
158	Plot No. 169	4588.24
159	Plot No. 170	4588.24
160	Plot No. 171	4588.24
161	Plot No. 172	4588.24
162	Plot No. 173	4588.24
163	Plot No. 174	4588.24
164	Plot No. 175	4588.24
165	Plot No. 176	4588.24
166	Plot No. 177	4588.24
167	Plot No. 178	4588.24
168	Plot No. 179	4588.24
169	Plot No. 180	4588.24
170	Plot No. 181	4588.24
171	Plot No. 182	4588.24
172	Plot No. 183	4588.24
173	Plot No. 184	4588.24
174	Plot No. 185	4588.24
175	Plot No. 186	4588.24
176	Plot No. 187	4588.24
177	Plot No. 188	4588.24
178	Plot No. 189	4588.24
179	Plot No. 190	4588.24
180	Plot No. 191	4588.24
181	Plot No. 192	4588.24
182	Plot No. 193	4588.24
183	Plot No. 194	4588.24
184	Plot No. 195	4588.24
185	Plot No. 196	4588.24
186	Plot No. 197	4588.24
187	Plot No. 198	4588.24
188	Plot No. 199	4588.24
189	Plot No. 200	4588.24
190	Plot No. 201	4588.24
191	Plot No. 202	4588.24
192	Plot No. 203	4588.24
193	Plot No. 204	4588.24
194	Plot No. 205	4588.24
195	Plot No. 206	4588.24
196	Plot No. 207	4588.24
197	Plot No. 208	4588.24
198	Plot No. 209	4588.24
199	Plot No. 210	4588.24
200	Plot No. 211	4588.24
201	Plot No. 212	4588.24
202	Plot No. 213	4588.24
203	Plot No. 214	4588.24
204	Plot No. 215	4588.24
205	Plot No. 216	4588.24
206	Plot No. 217	4588.24
207	Plot No. 218	4588.24
208	Plot No. 219	4588.24
209	Plot No. 220	4588.24
210	Plot No. 221	4588.24
211	Plot No. 222	4588.24
212	Plot No. 223	4588.24
213	Plot No. 224	4588.24
214	Plot No. 225	4588.24
215	Plot No. 226	4588.24
216	Plot No. 227	4588.24
217	Plot No. 228	4588.24
218	Plot No. 229	4588.24
219	Plot No. 230	4588.24
220	Plot No. 231	4588.24
221	Plot No. 232	4588.24
222	Plot No. 233	4588.24
223	Plot No. 234	4588.24
224	Plot No. 235	4588.24
225	Plot No. 236	4588.24
226	Plot No. 237	4588.24
227	Plot No. 238	4588.24
228	Plot No. 239	4588.24
229	Plot No. 240	4588.24
230	Plot No. 241	4588.24
231	Plot No. 242	4588.24
232	Plot No. 243	4588.24
233	Plot No. 244	4588.24
234	Plot No. 245	4588.24
235	Plot No. 246	4588.24
236	Plot No. 247	4588.24
237	Plot No. 248	4588.24
238	Plot No. 249	4588.24
239	Plot No. 250	4588.24
240	Plot No. 251	4588.24
241	Plot No. 252	4588.24
242	Plot No. 253	4588.24
243	Plot No. 254	4588.24
244	Plot No. 255	4588.24
245	Plot No. 256	4588.24
246	Plot No. 257	4588.24
247	Plot No. 258	4588.24
248	Plot No. 259	4588.24
249	Plot No. 260	4588.24
250	Plot No. 261	4588.24
251	Plot No. 262	4588.24
252	Plot No. 263	4588.24
253	Plot No. 264	4588.24
254	Plot No. 265	4588.24
255	Plot No. 266	4588.24
256	Plot No. 267	4588.24
257	Plot No. 268	4588.24
258	Plot No. 269	4588.24
259	Plot No. 270	4588.24
260	Plot No. 271	4588.24
261	Plot No. 272	4588.24
262	Plot No. 273	4588.24
263	Plot No. 274	4588.24
264	Plot No. 275	4588.24
265	Plot No. 276	4588.24
266	Plot No. 277	4588.24
267	Plot No. 278	4588.24
268	Plot No. 279	4588.24
269	Plot No. 280	4588.24
270	Plot No. 281	4588.24
271	Plot No. 282	4588.24
272	Plot No. 283	4588.24
273	Plot No. 284	4588.24
274	Plot No. 285	4588.24
275	Plot No. 286	4588.24
276	Plot No. 287	4588.24
277	Plot No. 288	4588.24
278	Plot No. 289	4588.24
279	Plot No. 290	4588.24
280	Plot No. 291	4588.24
281	Plot No. 292	4588.24
282	Plot No. 293	4588.24
283	Plot No. 294	4588.24
284	Plot No. 295	4588.24
285	Plot No. 296	4588.24
286	Plot No. 297	4588.24
287	Plot No. 298	4588.24
288	Plot No. 299	4588.24
289	Plot No. 300	4588.24
290	Plot No. 301	4588.24
291	Plot No. 302	4588.24
292	Plot No. 303	4588.24
293	Plot No. 304	4588.24
294	Plot No. 305	4588.24
295	Plot No. 306	4588.24
296	Plot No. 307	4588.24
297	Plot No. 308	4588.24
298	Plot No. 309	4588.24
299	Plot No. 310	4588.24
300	Plot No. 311	4588.24
301	Plot No. 312	4588.24
302	Plot No. 313	4588.24
303	Plot No. 314	4588.24
304	Plot No. 315	4588.24
305	Plot No. 316	4588.24
306	Plot No. 317	4588.24
307	Plot No. 318	4588.24
308	Plot No. 319	4588.24
309	Plot No. 320	4588.24
310	Plot No. 321	4588.24
311	Plot No. 322	4588.24
312	Plot No. 323	4588.24
313	Plot No. 324	4588.24
314	Plot No. 325	4588.24
315	Plot No. 326	4588.24
316	Plot No. 327	4588.24
317	Plot No. 328	4588.24
318	Plot No. 329	4588.24
319	Plot No. 330	4588.24
320	Plot No. 331	4588.24
321	Plot No. 332	4588.24
322	Plot No. 333	4588.24
323	Plot No. 334	4588.24
324	Plot No. 335	4588.24
325	Plot No. 336	4588.24
326	Plot No. 337	4588.24
327	Plot No. 338	4588.24
328	Plot No. 339	4588.24
329	Plot No. 340	4588.24
330	Plot No. 341	4588.24
331	Plot No. 342	4588.24
332	Plot No. 343	4588.24
333	Plot No. 344	4588.24
334	Plot No. 345	4588.24
335	Plot No. 346	4588.24
336	Plot No. 347	4588.24
337	Plot No. 348	4588.24
338	Plot No. 349	4588.24
339	Plot No. 350	4588.24
340	Plot No. 351	4588.24
341	Plot No. 352	4588.24
342	Plot No. 353	4588.24
343	Plot No. 354	4588.24
344	Plot No. 355	4588.24
345	Plot No. 356	4588.24
346	Plot No. 357	4588.24
347	Plot No. 358	4588.24
348	Plot No. 359	4588.24
349	Plot No. 360	